

Chippewa County

Zoom In Zoom Out Pan Zoom Prev Zoom Next Zoom Select Zoom Extent Legend Results Clear

Navigation View

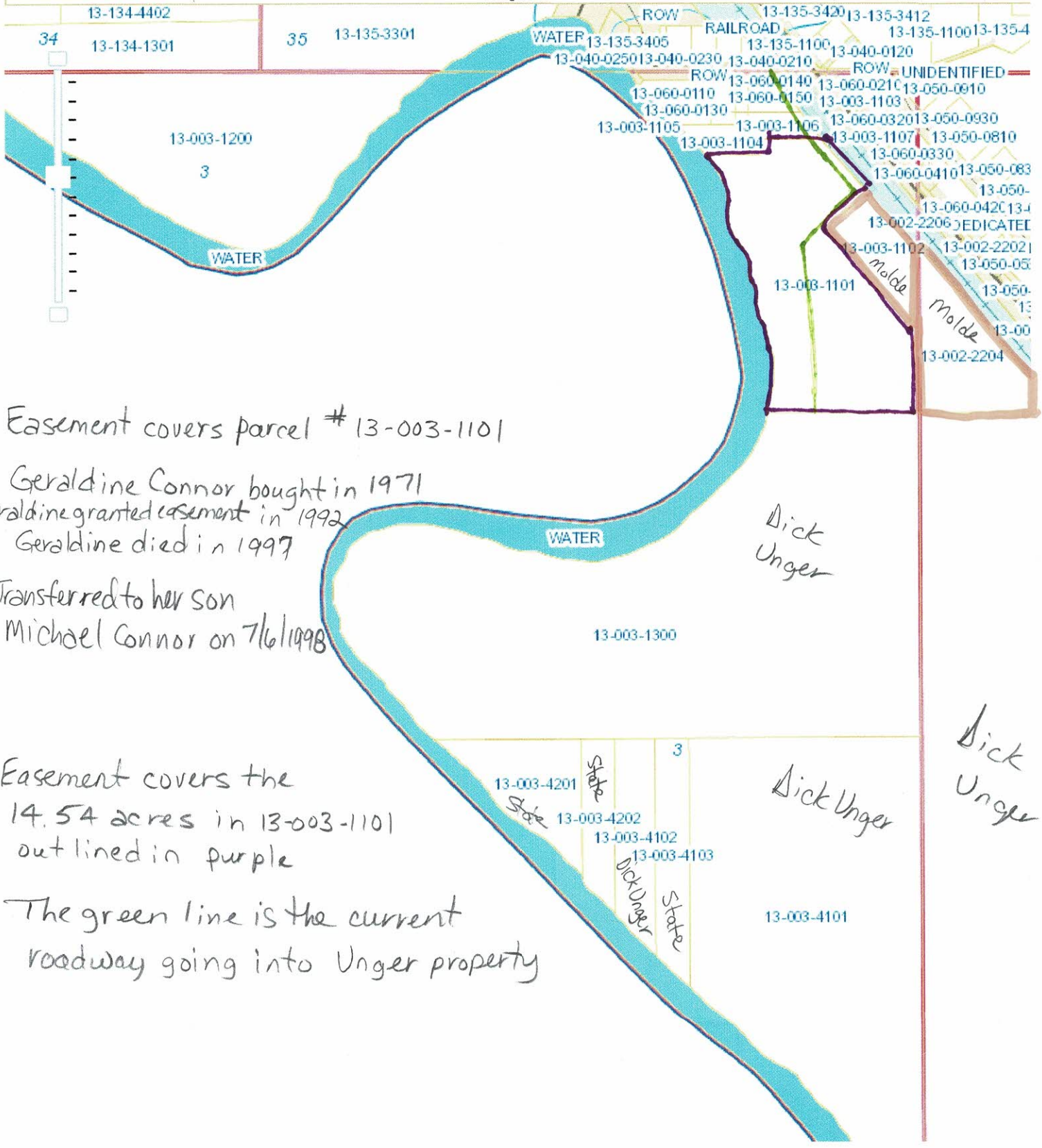

Easement covers parcel # 13-003-1101

Geraldine Connor bought in 1971
 Geraldine granted easement in 1992
 Geraldine died in 1997

Transferred to her son
 Michael Connor on 7/6/1998

Easement covers the
 14.54 acres in 13-003-1101
 outlined in purple

The green line is the current
 roadway going into Unger property

Dick Unger

Dick Unger

Dick Unger